

Diablo Built-In

Standard Features	
Diablo Built-In	#62648CE-LPG #62649CE-NG
Recommended Use	Commercial Residential
Cooking Power-kWh	30.90 kWh
Burners	6 - Cast S/Steel Bar Burners
Infrared Back Burner	
Cast Stainless Steel Double Side Burners	✘
Piezo Igniter	✔
Zinc Knobs	✔
Stainless Steel 304 Gauge	2.00 mm
Single Piece SS Dual Lined Hood	✔
Solid Stainless Steel Grates	✔
Heavy Duty Thermometer	✔
Solid S/Steel Warming Rack	✔
Stainless Steel Rotisserie Motor	✔
Stainless Steel Grease Tray	✔
Stainless Steel Side Shelves	✔
Twin Lighting System	✔
SS 304 Double Door Storage Cart	✘
SS 304 Door/Drawer Storage Cart	✘
Heavy Duty Castors	✔
CSA Certified	✔
CE Certified	✔
Lower Cooking Surface	115x 49 cm
Upper Cooking Surface	115x 18 cm
Warranty Details	
Fire Box & Roasting Hood	Lifetime
Cooking Grates	Lifetime
Burners	Lifetime
Flame Tamers	5 Years
Packing Dimensions	
Grill Carton Length	127 cm
Grill Carton Width	66 cm
Grill Carton Height	62 cm
Grill Carton Cube	0.52M ³
Grill Carton Weight	90.00 Kg
Cart Bottom Packing Dimensions	
Cart Carton Length	
Cart Carton Width	
Cart Carton Height	
Cart Carton Cube	
Cart Carton Weight	

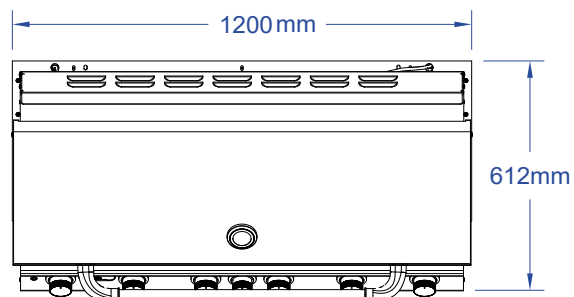

The Diablo grill is a 6-Burner 117cm stainless steel built-in gas barbecue grill with an Infrared back burner and rotisserie. Our largest Grill, the Diablo boasts a whopping 31 kWh of cooking power and comes standard with our Reliabull heat technology that reduces hot and cold spots creating a more even grilling surface.



Top View

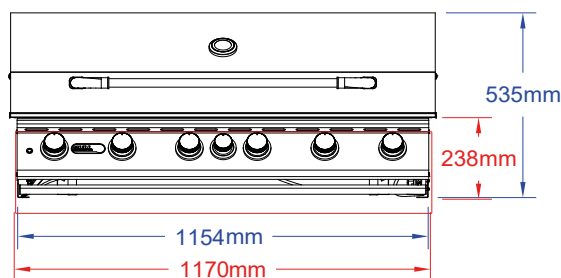

Front View

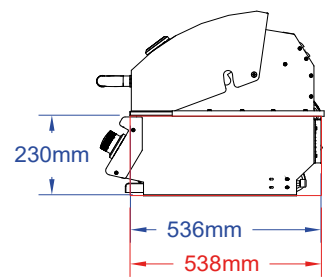

Side View

*Red measurements shown are the recommended cut-out dimensions