

URBAN
Bonfire[™]
 URBAIN

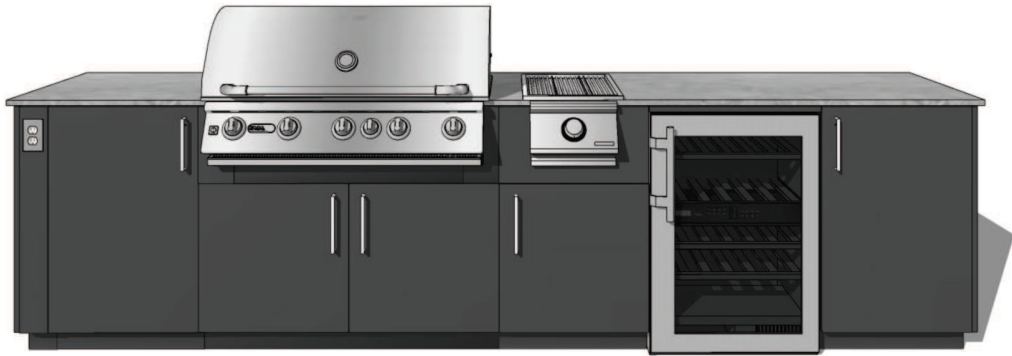

EVERY URBAN BONFIRE[™] OUTDOOR KITCHEN DESIGN INCLUDES:

- Thick Marine Grade Aluminum Construction
- Full Interior and Exterior Electrostatic Powder Coating
- Adjustable Commercial Grade 304 Stainless Steel Leveling Legs
- Matching Powder Coated Integrated Self-Leveling Toe Kick
- Compatibility with all Major Grill Brands and Outdoor Cooking Accessories
- Compatibility with Dekton, Sensa and Most Outdoor Countertop Surfaces
- 304 Stainless Steel Handles and Interior Hardware
- Ten-Year Limited Warranty

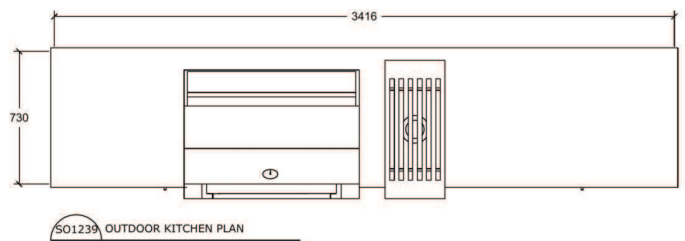
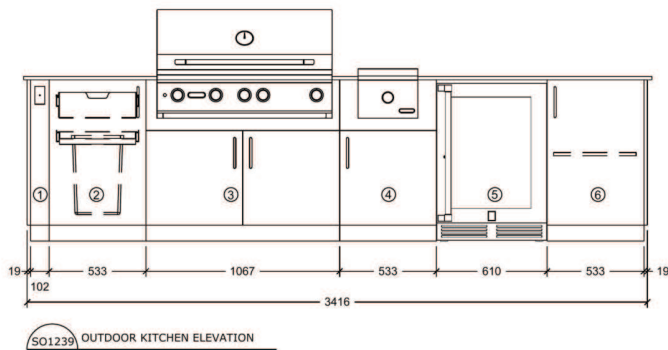

DESIGN CONSIDERATIONS:

- Powder Coating: Anthracite
- Handle Model: Stainless Steel
- Side Panels: 28.75"
- Back panels Included: Yes or No
- Countertop Thickness: 3/4"
- Appliances: Bull grill, Bull side burner, 24" fridge
- Gas Type: NG or Propane

Print Name: _____

Client Signature: _____

Date: _____

URBAN
Bonfire[™]
 URBAIN



EVERY URBAN BONFIRE[™] OUTDOOR KITCHEN DESIGN INCLUDES:

- Thick Marine Grade Aluminum Construction
- Full Interior and Exterior Electrostatic Powder Coating
- Adjustable Commercial Grade 304 Stainless Steel Leveling Legs
- Matching Powder Coated Integrated Self-Leveling Toe Kick
- Compatibility with all Major Grill Brands and Outdoor Cooking Accessories
- Compatibility with Dekton, Sensa and Most Outdoor Countertop Surfaces
- 304 Stainless Steel Handles and Interior Hardware
- Ten-Year Limited Warranty

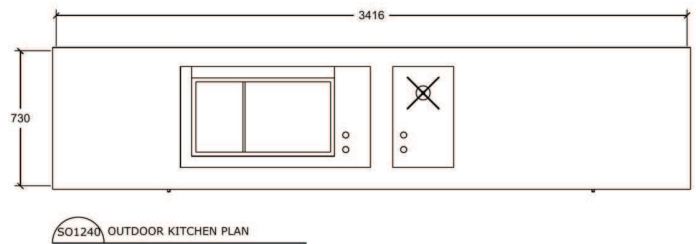
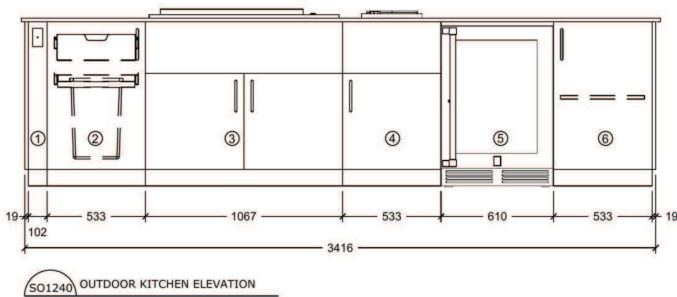

DESIGN CONSIDERATIONS:

- Powder Coating: Anthracite
- Handle Model: Stainless Steel
- Side Panels: 28.75"
- Back panels Included: Yes or No
- Countertop Thickness: 3/4"
- Appliances: Planet grill, Planet side burner, 24" fridge
- Gas Type: NG or Propane

Print Name: _____

Client Signature: _____

Date: _____